







motor operator 24-60V DC accessory for: 3VA1 400/630 3VA2 400/630



Model	
product brand name	SENTRON
product designation	Accessories
Product version	Motorized operating mechanism (MO)
General technical data	
Voltage	
Type de tension pour la commande	AC/DC
Rated operational power	250 V·A
Current	
Mechanical Design	
Rated control supply voltage U_s with DC	24 V
Height	92 mm
Width	137.6 mm
depth	149 mm
net weight	1 310 g
connectable conductor cross-section / solid	
• minimum	1.5 mm ²
• maximum	2.5 mm ²
connectable conductor cross-section / finely stranded / with core end processing	
• minimum	1.5 mm ²
• maximum	2.5 mm ²
connectable conductor cross-section / stranded	
• minimum	1.5 mm ²
• maximum	2.5 mm ²
ambient temperature / during operation	
• minimum	-25 °C
• maximum	70 °C
ambient temperature / during storage	
• minimum	-40 ... +80
• maximum	
tightening torque	
• minimum	0.36 N·m
• maximum	0.44 N·m
Connections according IEC	
stripped length	7 mm
Connections according UL	

Certificates

General Product Approval	EMC	Declaration of Conformity			
Miscellaneous		 RCM	 EG-Konf.	 EG-Konf.	 EG-Konf.
Declaration of Conformity	Shipping Approval	other			
 EG-Konf.	 LRS	Manufacturer Declaration	Miscellaneous		

Further information

Information- and Downloadcenter (Catalogs, Brochures,...)

<http://www.siemens.com/lowvoltage/catalogs>

Industry Mall (Online ordering system)

<https://mall.industry.siemens.com/mall/en/en/Catalog/product?mlfb=3VA9467-0HA10>

Service&Support (Manuals, Certificates, Characteristics, FAQs,...)

<https://support.industry.siemens.com/cs/ww/en/ps/3VA9467-0HA10>

Image database (product images, 2D dimension drawings, 3D models, device circuit diagrams, ...)

http://www.automation.siemens.com/bilddb/cax_en.aspx?mlfb=3VA9467-0HA10

Tender specifications

<http://www.siemens.com/specifications>

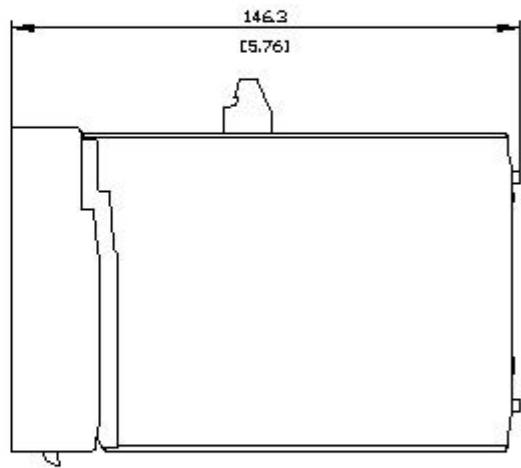
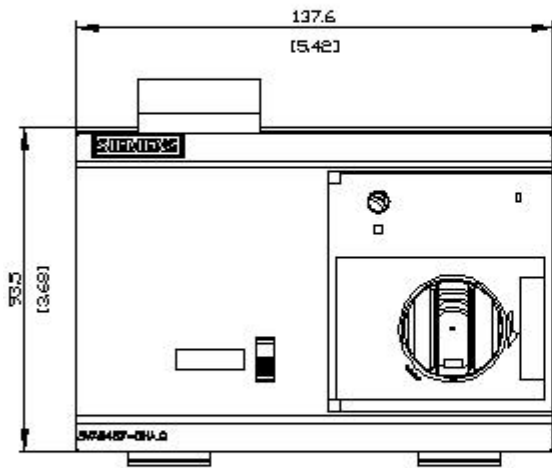

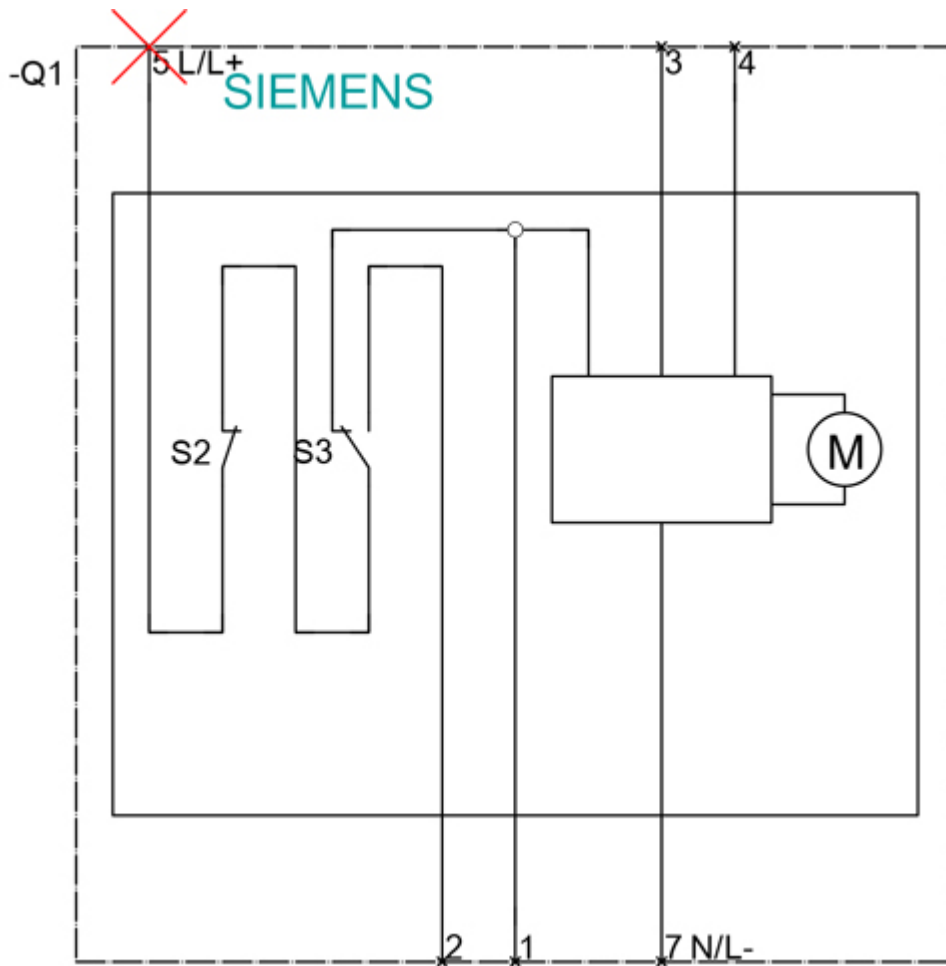

last modified:

12/18/2020 